

## IP6K9K

### 触点参数 / Contact parameters

		1a			
		≤0.5mΩ (at 300A)			
		300A			
		2×10 <sup>-5</sup>			
		<b>450V型</b>		<b>750V型</b>	
		1000VDC		1000VDC	
		2500A(320VDC)1		2500A(320VDC)1	
		135kW		225kW	
1)		2.5×10 <sup>4</sup>	22.5VDC, =1ms	400A, 300A	1.5×10 <sup>4</sup> 37.5VDC, =1ms 400A, 300A
		1	360VDC, =1ms	1350A, 300A	
		1×10 <sup>4</sup>	450VDC,80A		1×10 <sup>4</sup> 750VDC,80A
		3×10 <sup>3</sup>	450VDC,300A		1×10 <sup>3</sup> 750VDC,300A
2)		300A:			
		450A:60min			
		600A:20min			
		1200A:30s			
		3000A:0.6s			

1) 85°C, 23°C, 0.6s:5.4s,

2) 85°C, 100 mm<sup>2</sup>, " "

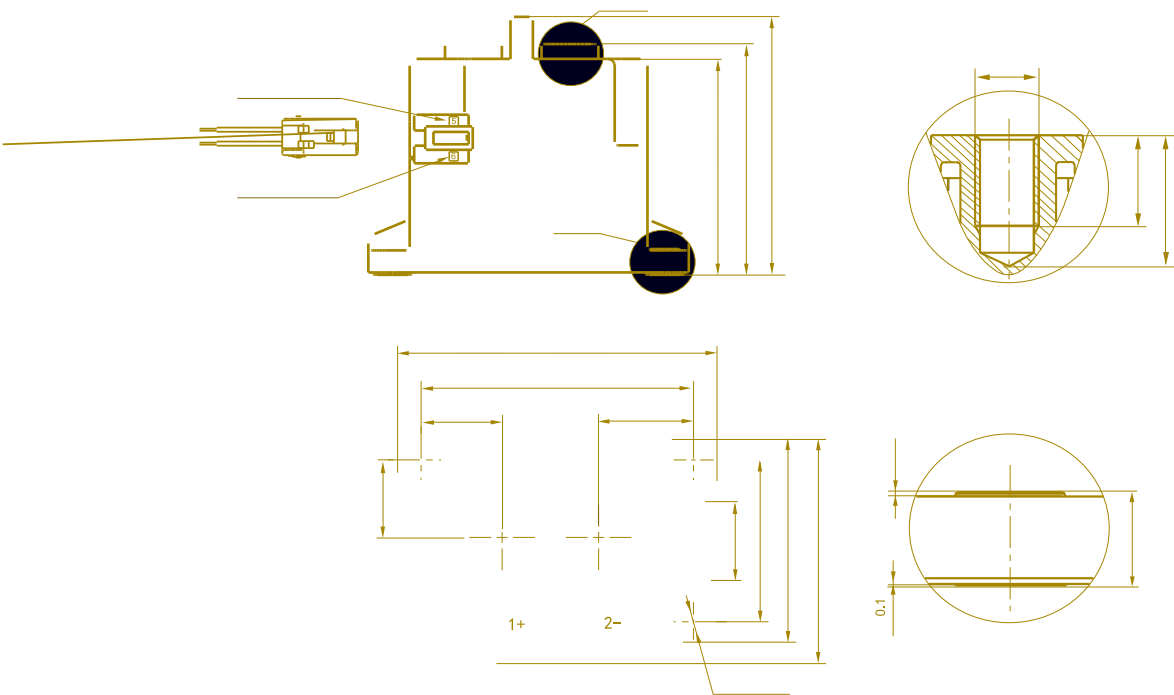

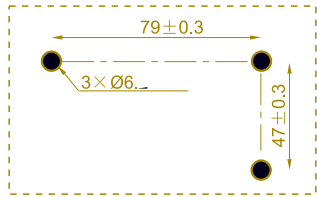

性能曲线图 Performance graph

Electrical life curve

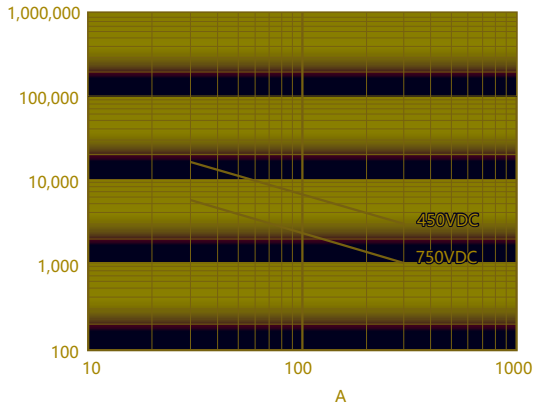

Tolerance curve

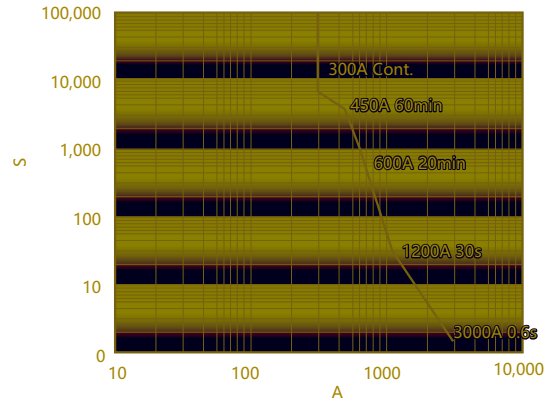

0.6S 5.4S

85°C, 100mm<sup>2</sup>



使用注意事项 Precautions for use

1 9N·m~11N·m。 M5 3N·m~4N·m

M6螺钉	9N·m~11N·m	Ø6.0~Ø6.5mm	5mm	M5螺钉	3N·m~4N·m
------	------------	-------------	-----	------	-----------

2 100mm<sup>2</sup>  
3 0.2s 0.2s  
4  
5 3mm



声明/Statement:

- 1、
- 2、